

# Insta-TEST<sup>®</sup>

10 Salt Water  
Test Strips

**Sodium  
Chloride**

1500-5000 ppm

Just dip & read!  
**READY IN 20 SECONDS!**

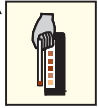
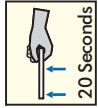
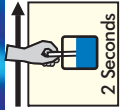

**Salt Water (SODIUM CHLORIDE) ppm**



1500



2000



2500



3000



3500



4000



5000

Dip pad into sample and immerse for 2 seconds. Remove strip with **pad face up. DO NOT SHAKE OFF EXCESS WATER.** In shade, hold strip level for **20 seconds and compare to color chart.** Discard strip after 30 seconds.

**TIPS**

- Keep out of direct sun during testing.
- Keep wet fingers out of the bottle and close cap tightly.
- Store indoors in a cool, dry, dark place.

LaMotte Company, Chestertown, MD 21620 Made in **USA**  
[www.lamotte.com/insta](http://www.lamotte.com/insta)  
Code 2998

